

# a way to your home



## AJITNATH RESIDENCY - 2

### Site Address

Near ajitnath derasar,  
Besides Indraprasth, Pancheshwar tower Road,  
Jamnagar.

A Project Developed By :



जमी पे सजायें जम्बात

### Corporate Office :

4<sup>th</sup> floor, "ALFA", Near M.P. House,  
Opp. Sadguru Nagar, Saru-Section Road,  
Jamnagar. Ph. : 0288 2540091

website : [www.home-maker.in](http://www.home-maker.in)  
e-mail : [inquiry@home-maker.in](mailto:inquiry@home-maker.in)

### Builders & Developers :

<b>DHIMANT SHAH</b>	<b>DHIMANT SHAH</b>
<b>NISHITH SHAH</b>	<b>DIVYESH SHAH</b>
<b>97148 15158</b>	<b>98242 14452</b>

Consulting Engineer : "UTTAM ART", K. D. Complex, Indira road, , jamnagar.  
Structural Engineer : "NIRMAN ASSOCIATES", Modern Market, Jamnagar.  
Exterior Designer : Abhay Kotak, 090677 57677

- Note :
- (1) Payment of all extra work to be executed shall be made in advance.
  - (2) Stamp Duty towards registration shall be borne by the client.
  - (3) Municipal corporations & GEB charges, if any ,shall be borne by client.
  - (4) Any central or state govt. taxes, if applicable shall have to borne by the clients.
  - (5) All members shall have to essentially be the part of the society formed by the Association of members & shall abide by the society by-laws.

The information contained in this brochure is indicative of the kind of development that is proposed. It is prepared & issued in good faith and is for guidance only. It does not constitute part of an offer or contract. Subject to the approval of the authorities of in the interest of the continuing improvement, the promoters reserve the rights to change plans, No. of storeys, specifications of features without prior notice of obligation. Guidelines are enforced for not allowing grills, flower pots etc. to be fixed outside windows or any changes to be made in external elevation. All the images are just for idealization.

A PROJECT BY

**HOME MAKER**  
Since : 1982  
जमी पे सजायें जम्बात



## AJITNATH RESIDENCY - 2

@

pancheshwar tower  
2 & 3 bhk flats & shops

designed & printed by -  
KALAVI D : 98242 21002







AJITNATH  
RESIDENCY - 2





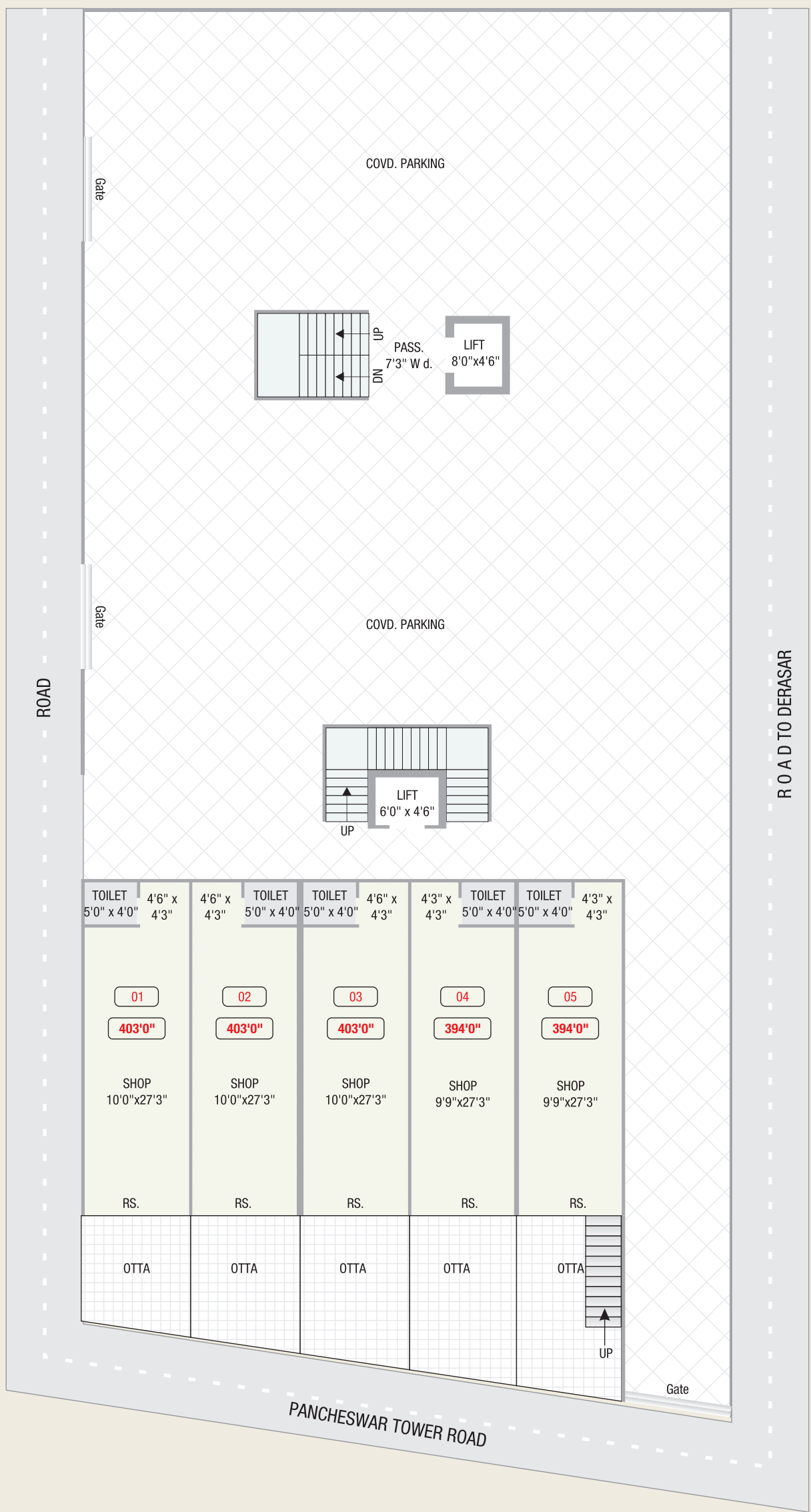

Ground Floor Plan

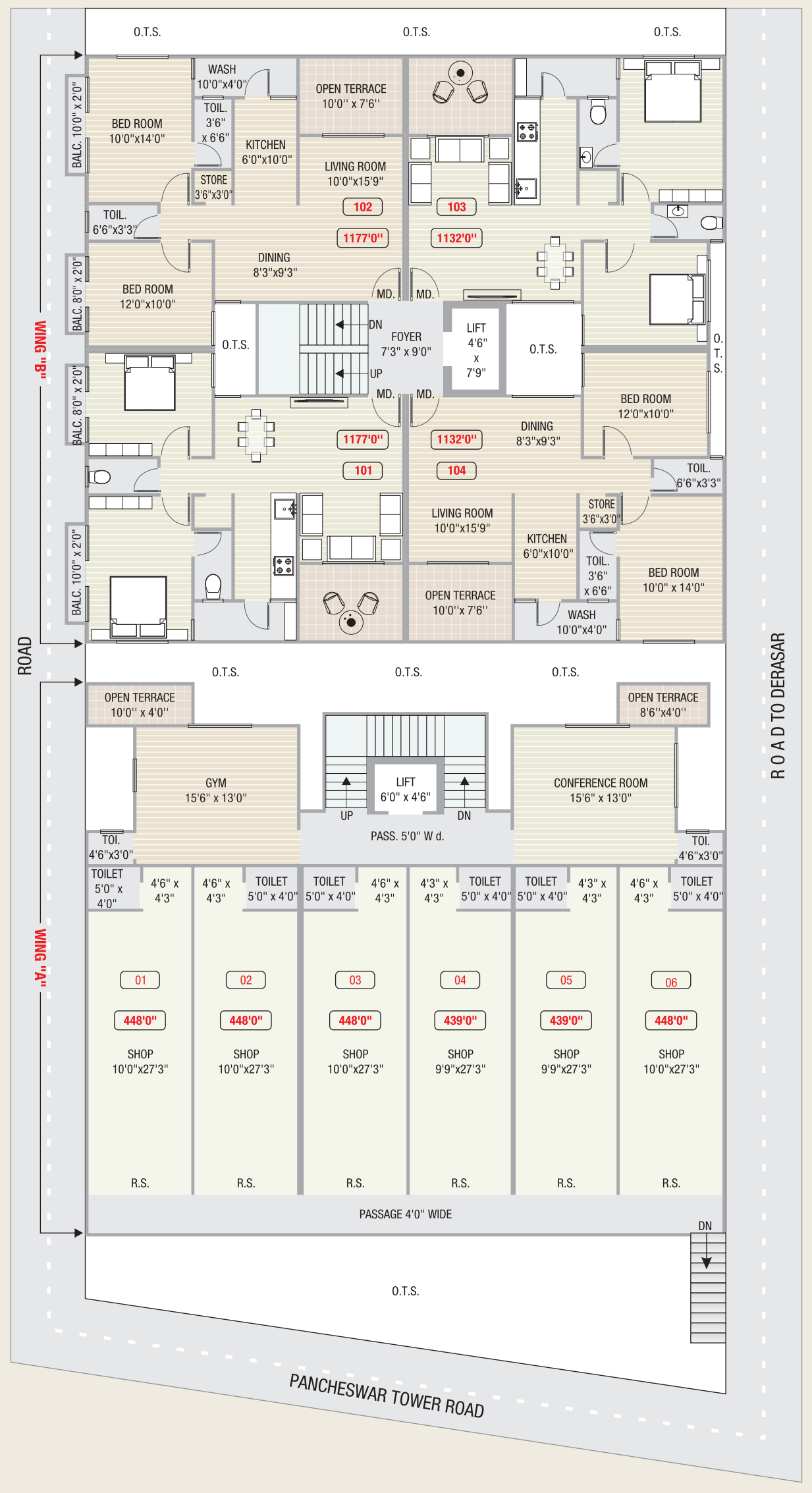

1<sup>st</sup> Floor Plan



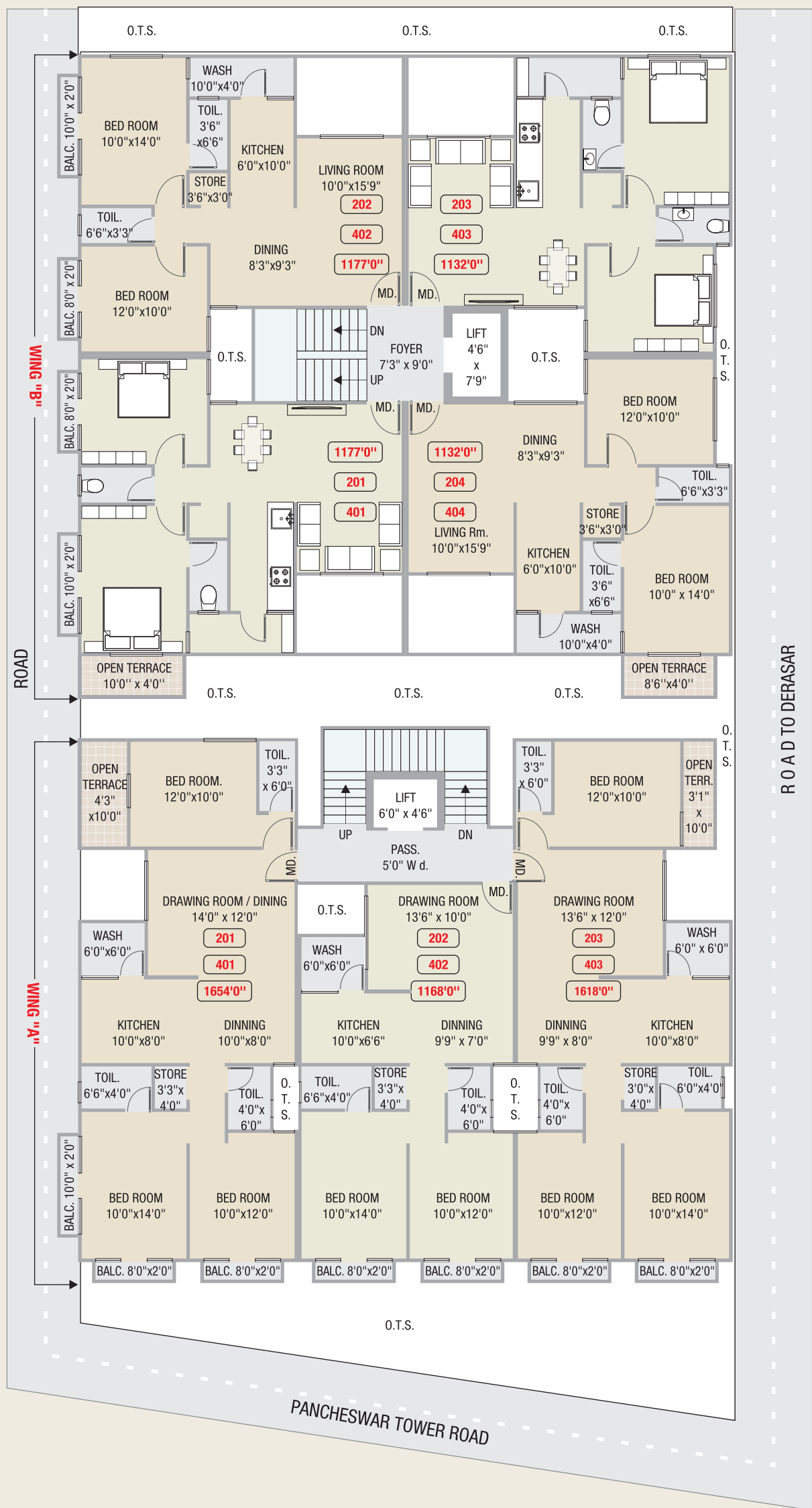

2<sup>nd</sup> & 4<sup>th</sup> Floor Plan

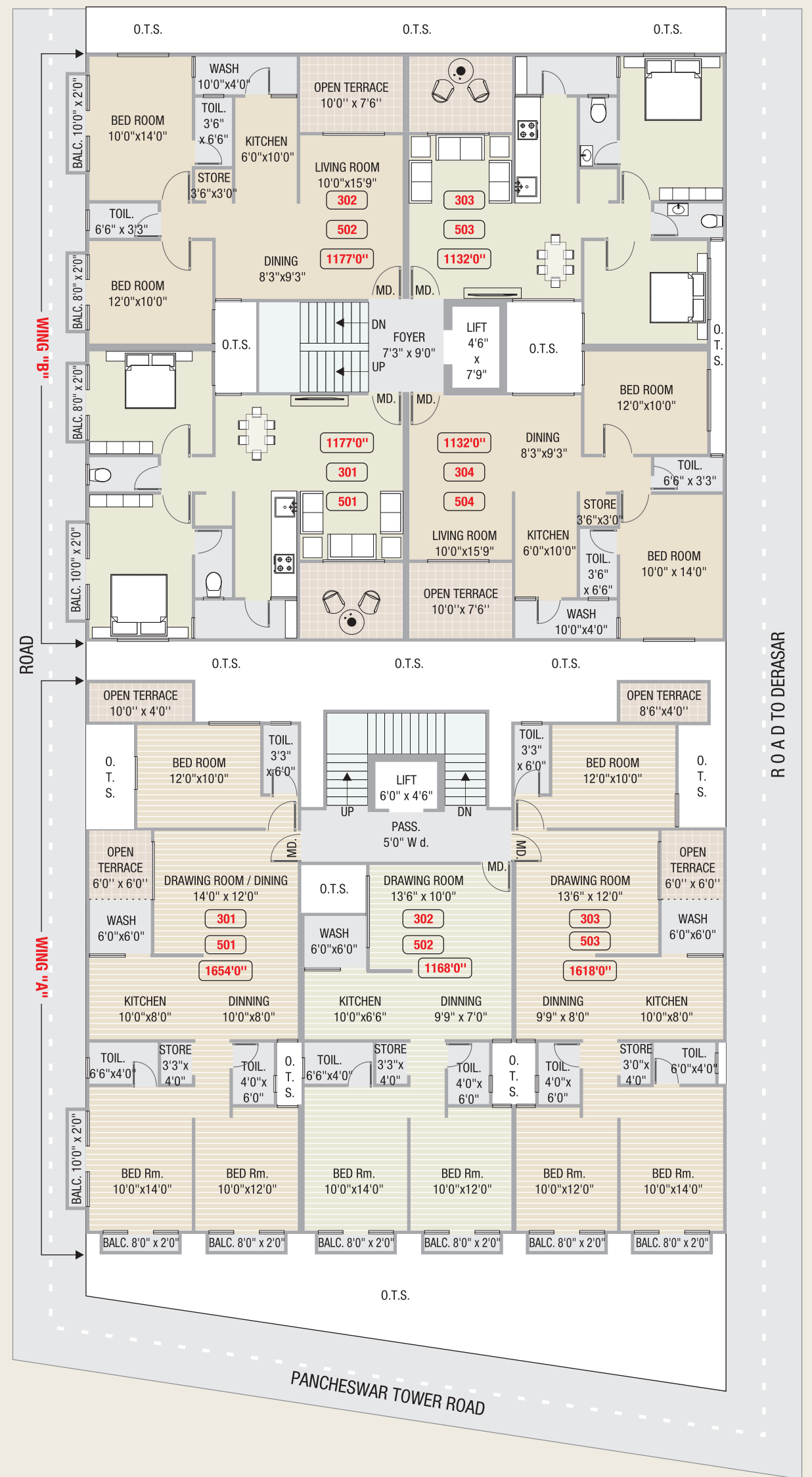

3<sup>rd</sup> & 5<sup>th</sup> Floor Plan





### Wing 'A' Plan



### Wing 'B' Plan





## Amenities

- Every flat breaths in full air and light.
- Marketable clear title and J.M.C approved building plan.
- Spacious & attractive entrance foyer.
- Modern health club
- Common multipurpose hall.
- Attractive main entrance gate and security reception.
- Each and Every flat has personal over-head water tank.
- Standard company's 2 (two) lifts.
- Flat to flat and flat to security intercom system.
- Power back-up for common area including elevator and parking.
- Beautiful and attractive elevation.
- Ample parking space at ground floor.
- Common toilet at ground floor
- Attractive name plat of flat owner's at ground floor



## Facilities

- Earthquake resistance R.C.C. Frame Structure as per structural design with good quality material
- Good quality masonry with good quality bricks
- Internal smooth plaster & sand face plaster on exterior surface
- Attractive main door and all other flush doors
- Three tracks powder coated aluminum section window
- Vitrified tiles flooring in all rooms of the apartment
- Finolex R/R Or equivalent company Cable concealed copper wiring with suitable MCB & ELCB in each apartment and elegant modular Switches
- Provisions for TV/Telephone / AC's. and other electronics appliances points
- Marble / Wooden / Granite Door Frames in bedrooms & toilets, balconies
- Good Quality granite platform with S.S. sink of Nirali or equivalent company and tiles up to slab level in kitchen
- Toilet : Attractive tiles up to slab level
- Attractive glaze tiles in wash area
- Concealed CPVC Plumbing With C.P. (Plumber/Jaquar) Fittings and Sanitary Wares (cera or simpolo)
- Emulsion paint on interior Walls & 100% Acrylic emulsion paint on exterior walls
- Water proofing in balconies, roof salb & toilet sunk slab